

National Shoreline Erosion Control Demonstration and Development Program



US Army Corps
of Engineers®

... demonstrating innovative coastal shoreline protection methods with an emphasis on evaluation of nontraditional approaches to prevent coastal erosion and improve shoreline sediment retention.



SECTION

227

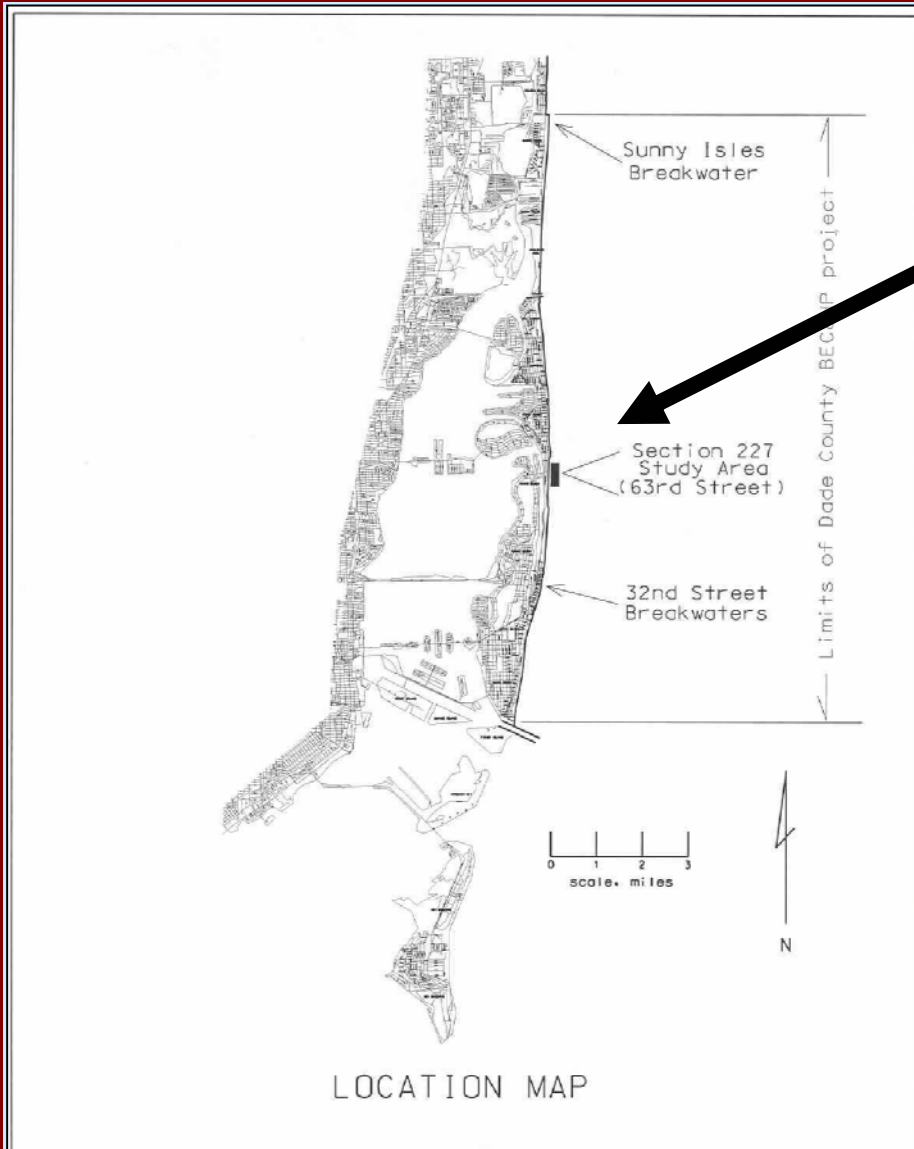

LOCATION MAP

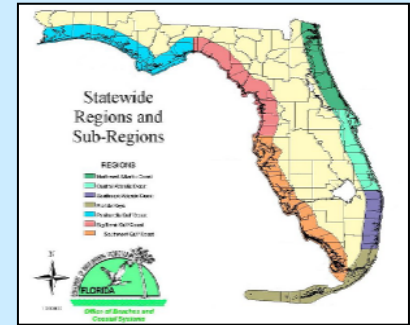

Dade County Beach Erosion Control Projects



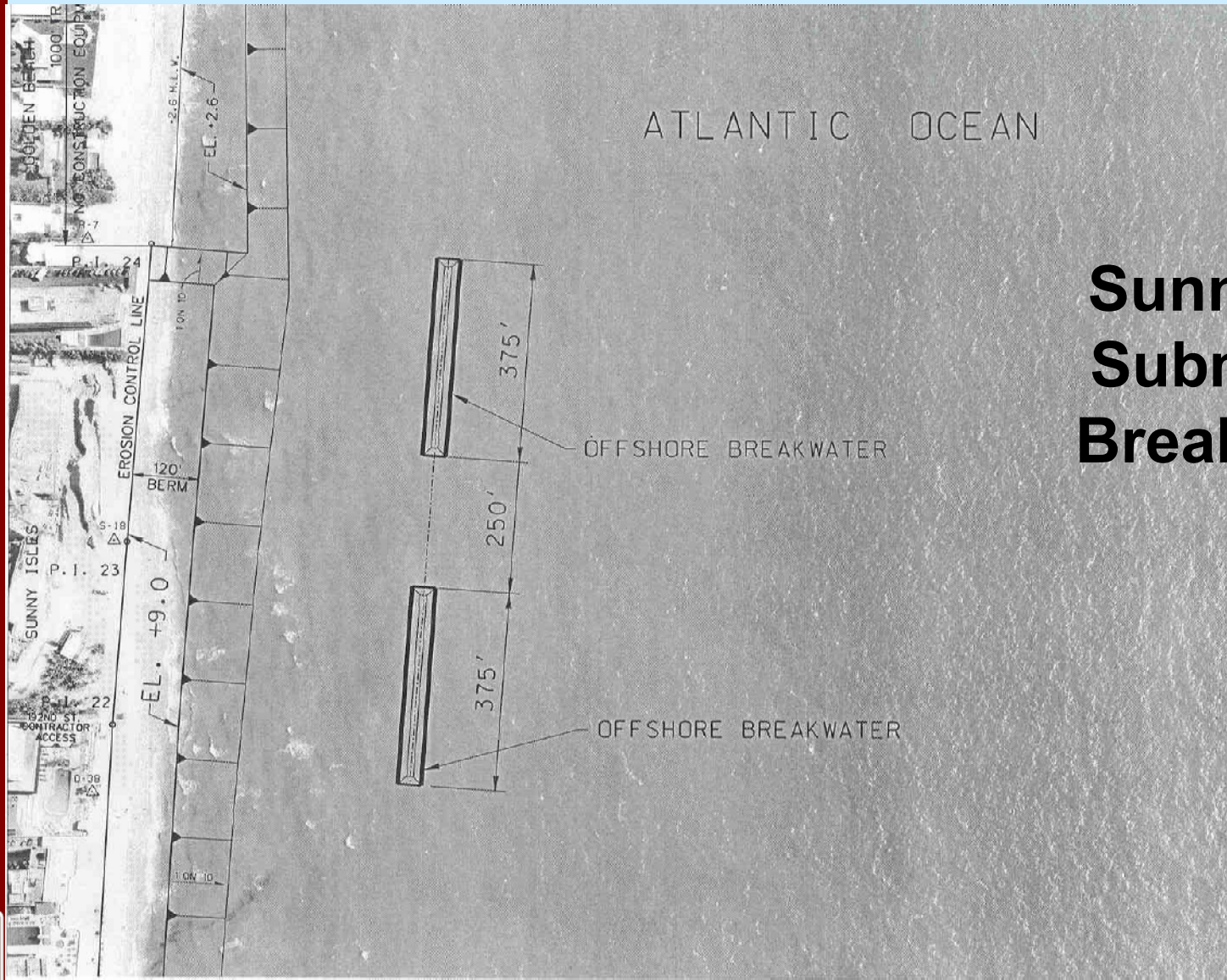

Sunny Isles Submerged Breakwaters

Sunny Isles Breakwaters

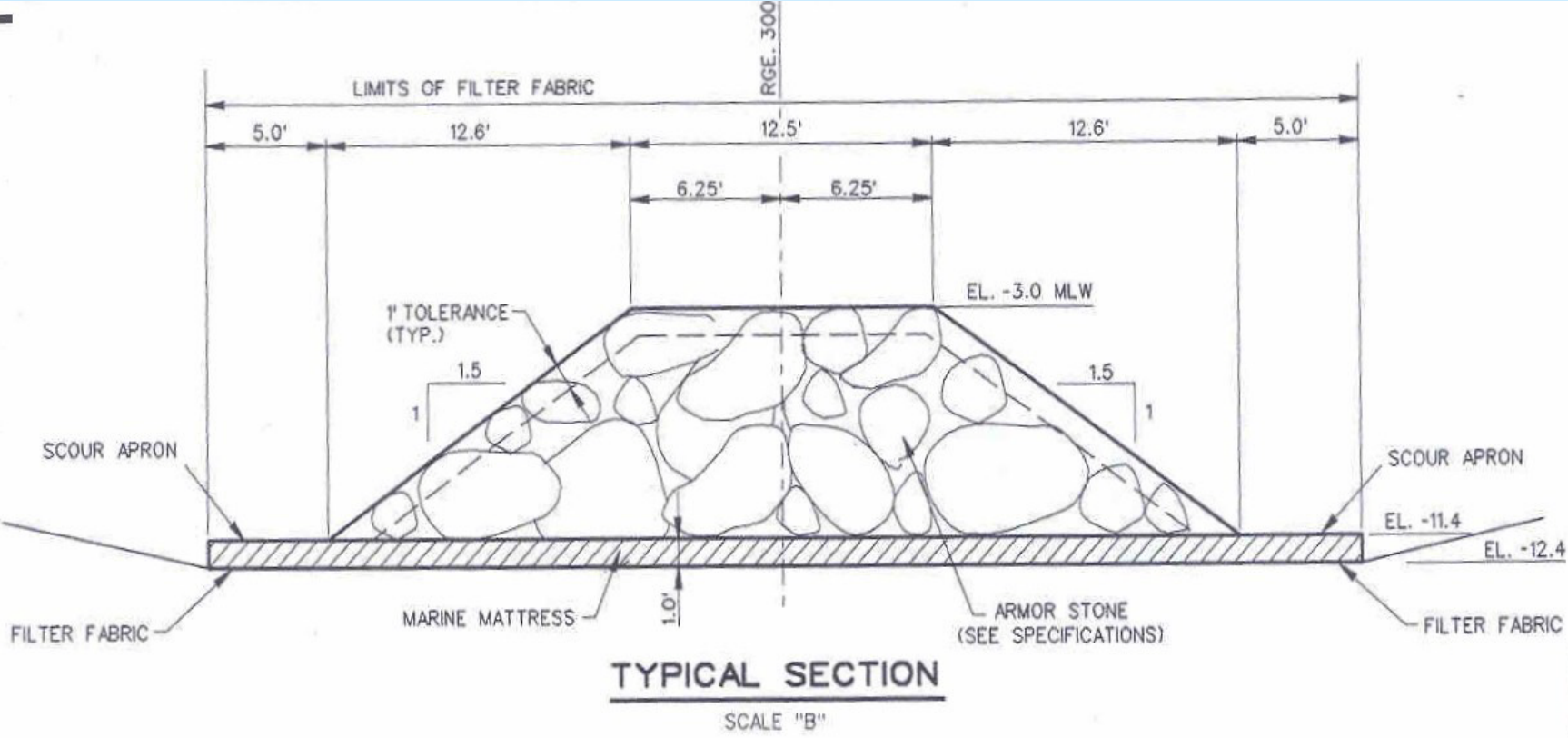



32nd Street Headland Breakwaters

32nd Street
Breakwaters



**32nd Street
Headland
Breakwaters**

Miami Beach, FL



2002 6 20





Historic
Change in
Hot Spot
Centroid
over Time

1935-36 USCGSmhw

1942-47 USCGSmhw

1919 USCGSmhw

63rd St.
Hot Spot

1867 USCGSmhw

1969 USGSmhw

1961-62 USGSmhw

1927-28 USCGSmhw

1971-75 NOSmhw

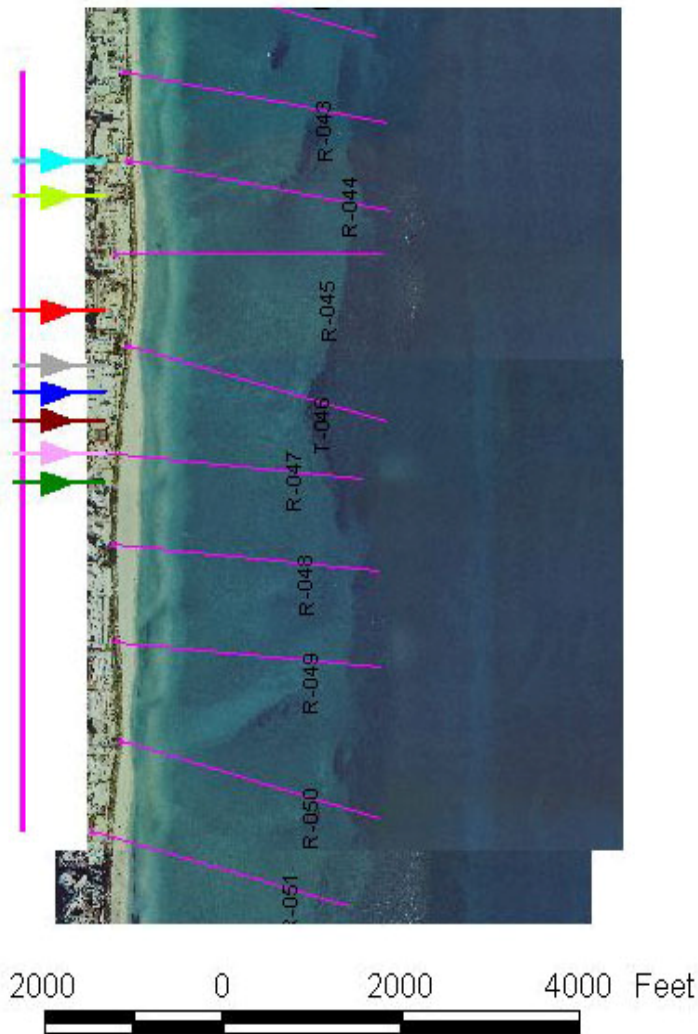

Miami
Beach,
FL

Typical Reef Balls

S
E
C
T
I
O
N

227

Maiden Island,
Antigua



Concrete Articulated Mat

S
E
C
T
I
O
N

227



Pouring a Reefball

SECTION

227



Wave Energy Dissipation Study

S
E
C
T
I
O
N

227



Physical Model Study

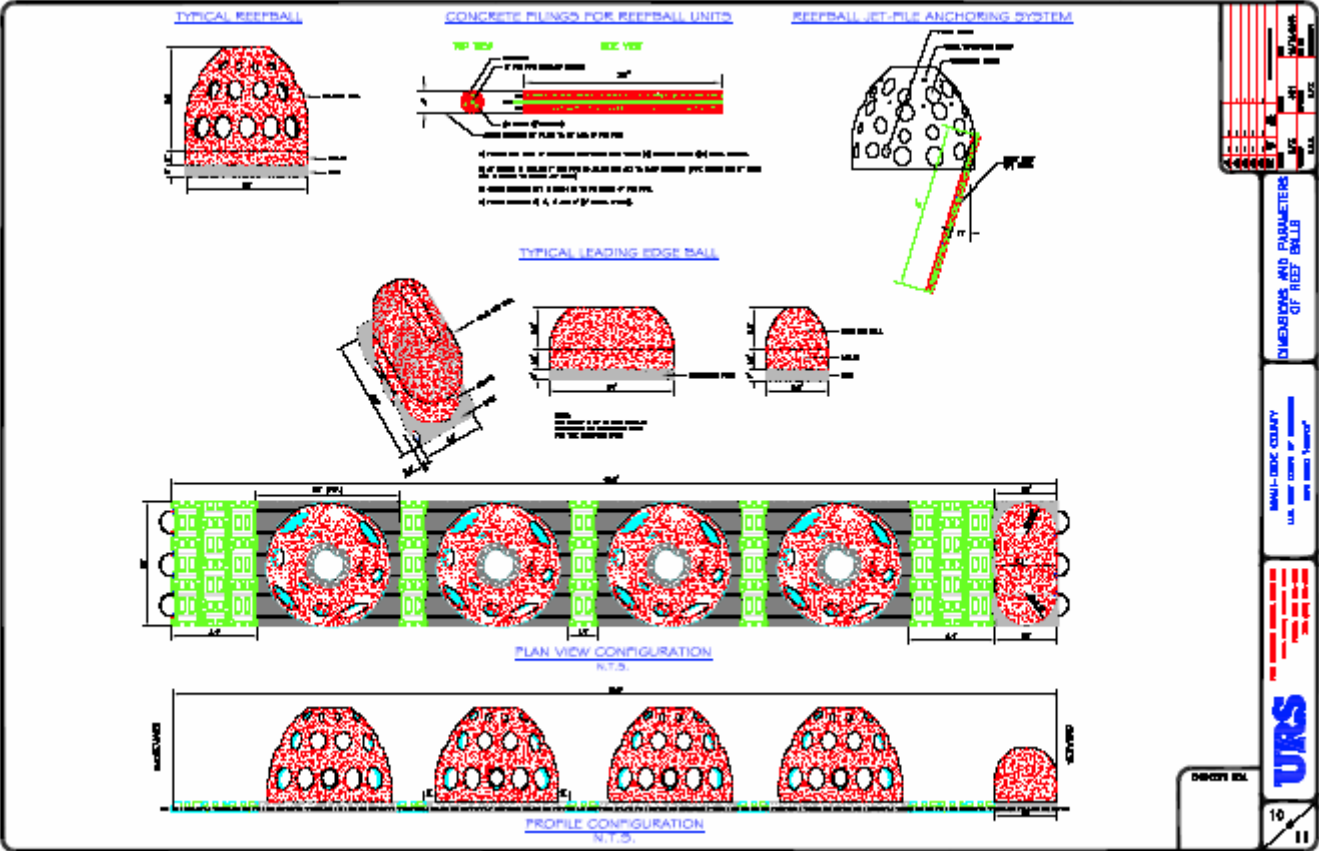

SECTION

227

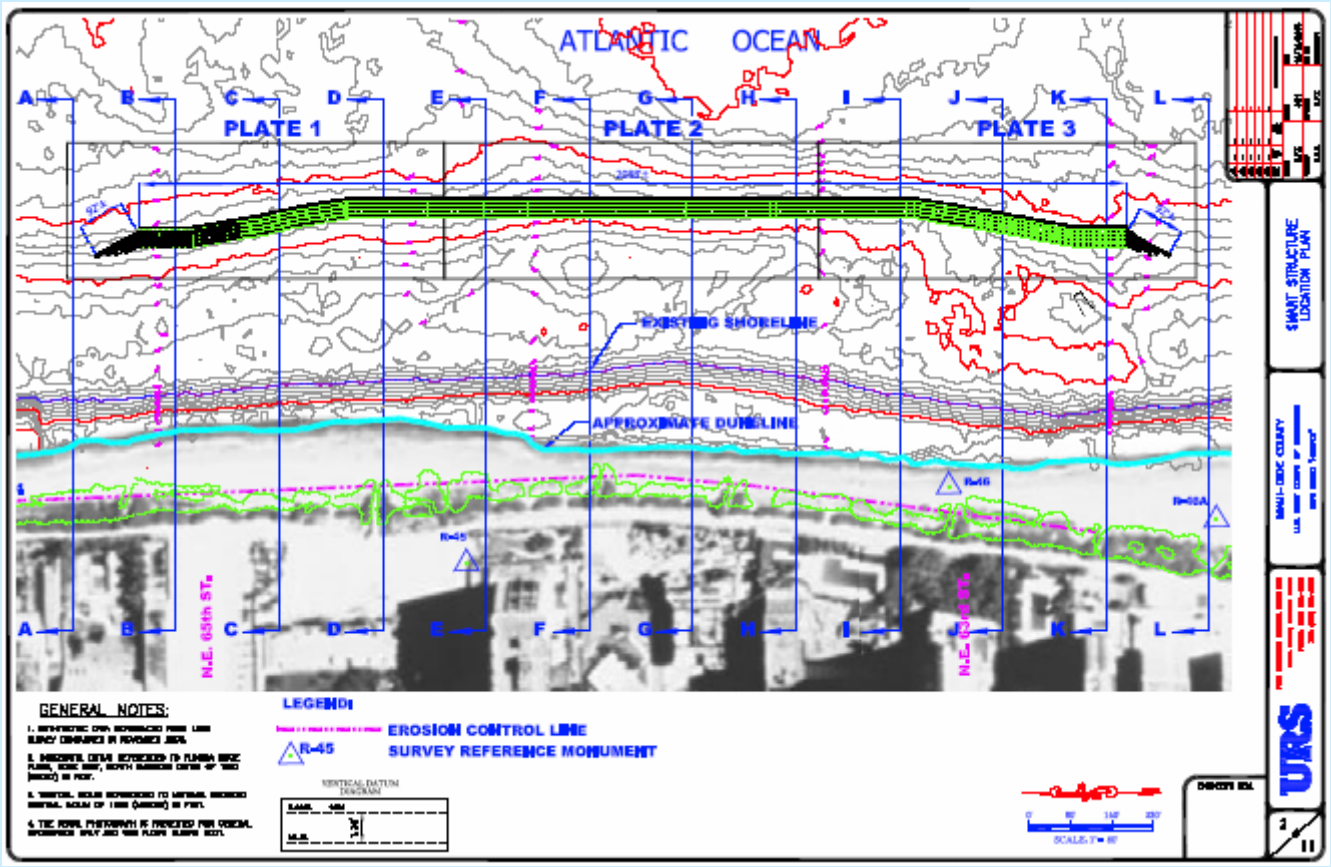

Advantages of a ReefBall Reef

- Stabilize the Beach!
- Provide excellent aquatic habitat
- Provide a rich and scenic snorkeling area
- Develop design guidance for Reefballs



Areas of Applicability

- Almost any wave environment
- Fresh- or saltwater
- Areas with shallow nearshore shelf
- Areas not subject to icing and ice floes



STATUS

(Major Milestones)

- Contract Awarded: April 2003
- Design Completion: December 2003
- Environmental/NEPA Coordination: Aug 2004
- Technical Review: August/September 2004
- Construction Complete: August 2005

