



33d Fighter Wing F-35 Brief



**Maj Michael "Jeb" Ebner,
58 FS, USAF**





Overview



- Team Eglin
- Integrated Training Center
- Facilities
- Planning & timelines
- F-35 Info
- Key Take Aways





Team Eglin



**DEFENSE THREAT
REDUCTION AGENCY**



AFRL MUNITIONS



AIR ARMAMENT CENTER



AFOTEC



53rd WING



20th SPCS



**NAVY EOD
SCHOOL**



**COAST
GUARD**



**ARMY
RANGERS**



**ARMY
7th SFG**



**919th SPECIAL
OPS WING**



33rd FW





Integrated Training Center



- Joint ITC - BRAC directed
 - “ This recommendation establishes Eglin Air Force Base, FL, as an Initial Joint Training Site that teaches entry-level aviators and maintenance technicians how to safely operate and maintain the new Joint Strike Fighter (JSF) (F-35) aircraft”
 - \$400M+ in MILCON and upgrades
 - 1600+ military, DoD civilian & contractor personnel
- Involves “shared resources”
 - Airspace
 - Facilities
 - CLS





F-35 Integrated Training Center (Eglin AFB) Command Relationships

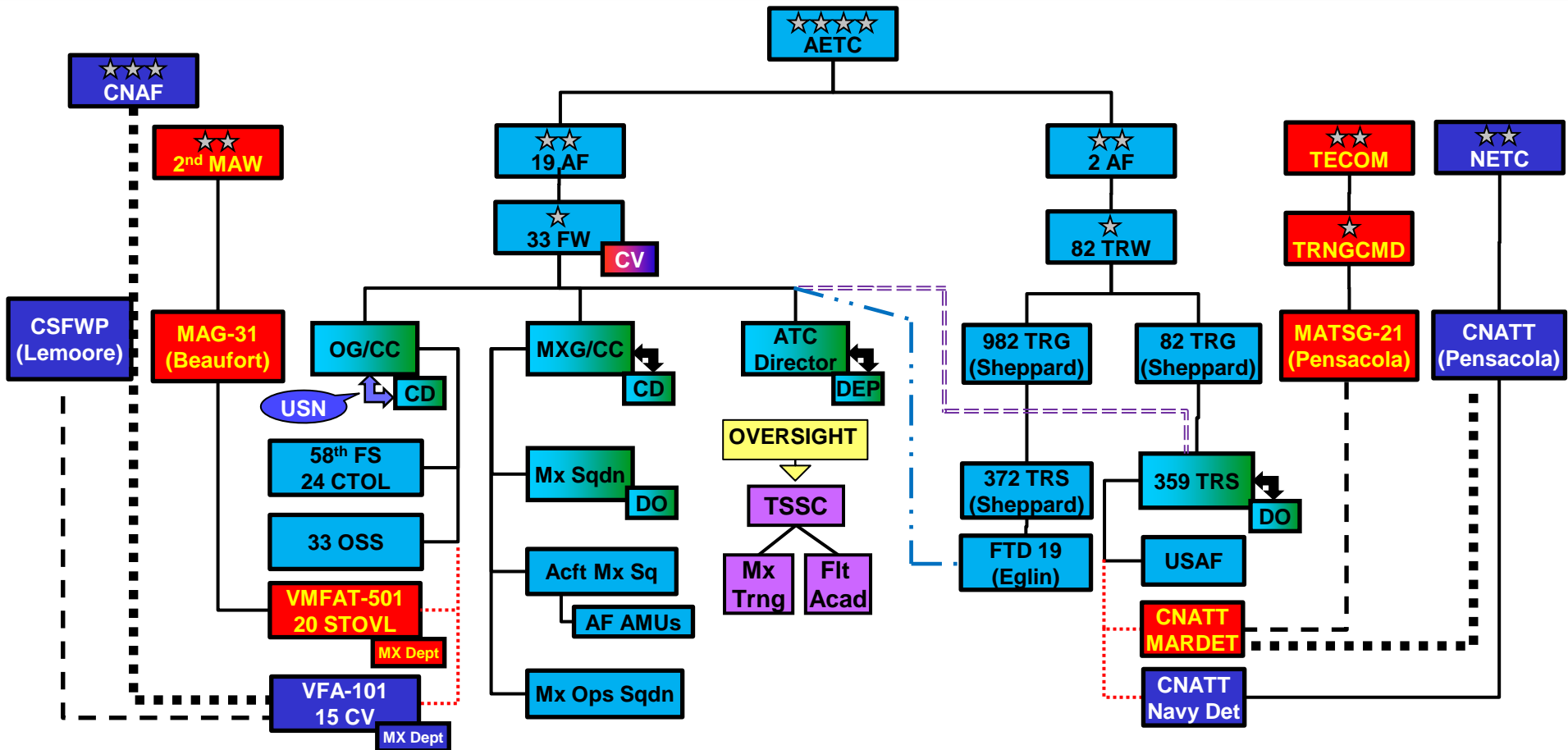

——— OPCON/ADCON
 - - - - - OPCON
 ADCON
 TACON (limited)
 - - - - - Attached/Other
 - - - - - Host Support

USAF
 USMC
 USN/USMC
 USN
 LM
 USAF/DoN



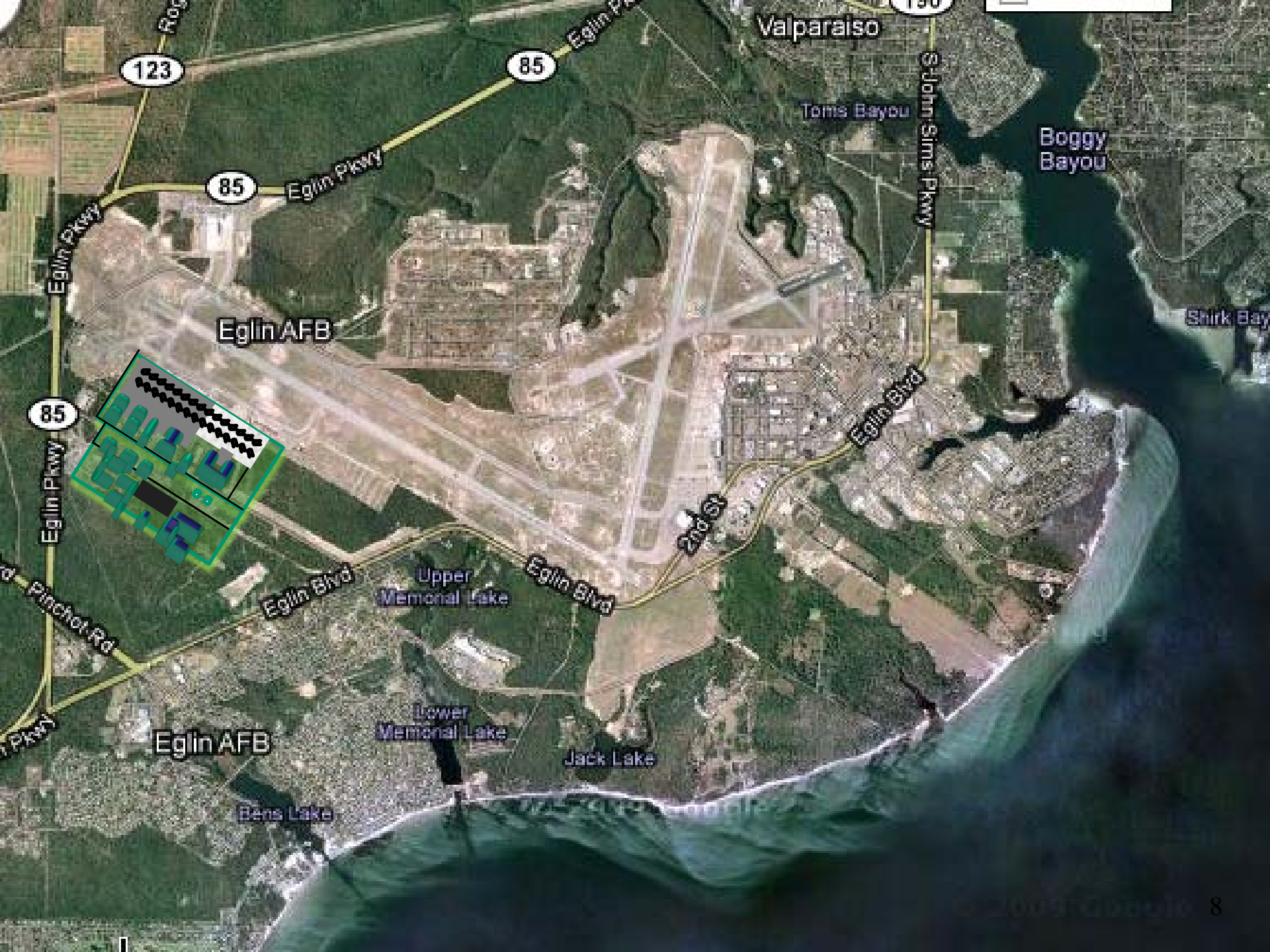

Integrated Training Center Campus

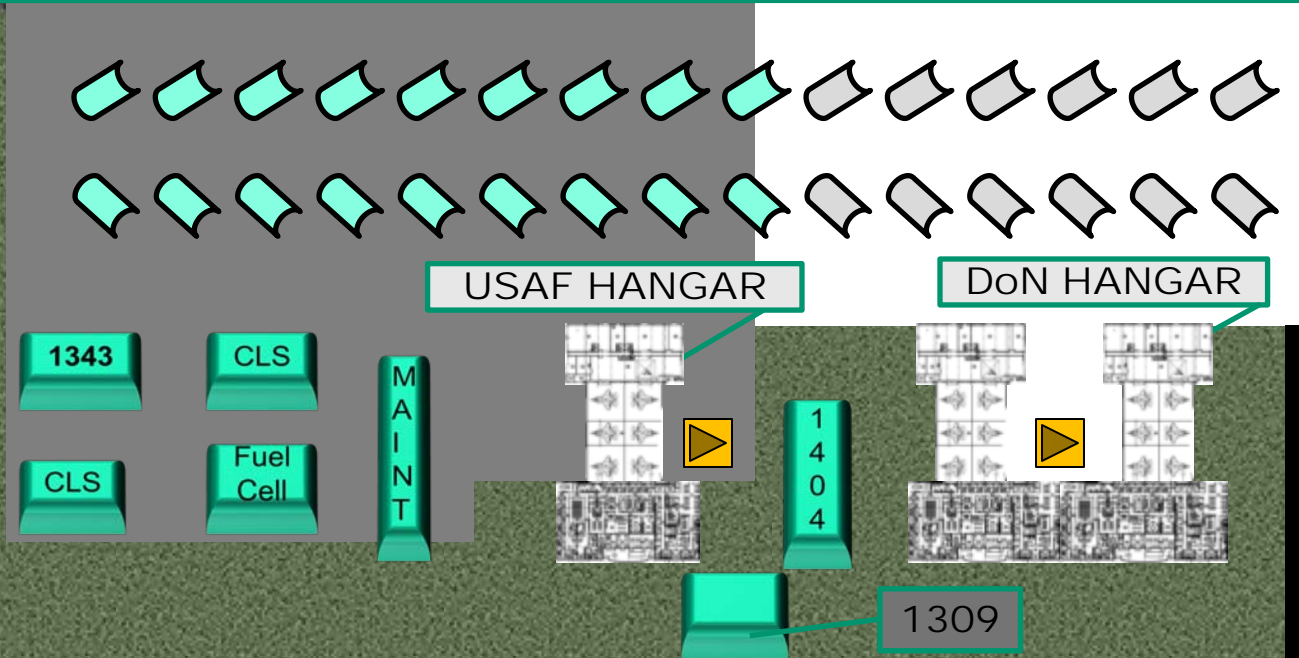

Existing

New

Growth



Track & USMC CFT

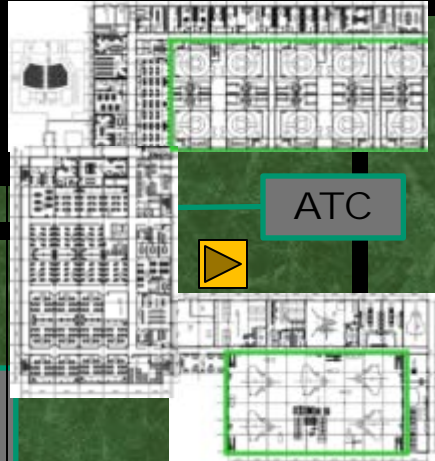



Eglin & Duke Upgrades

Eglin AFB



 New Concrete

Duke Field





33 FW Focus

Current Planning Dates

~ **Summer 2011**
Pilot Training

~ **Mar 2011**
Maint Training

Ready For
Training

Stand Up
Capabilities

Sustained
Production

OT

33 FW Core Cadre

USMC
Ops
Req

USAF
Ops
Req

USN
Ops
Req

INTL
Ops
Req

USMC
Annual
Req

USAF
Annual
Req

USN
Annual
Req

INTL
Annual
Req

- Facilities
- Equipment
- People
- Processes
- Small Group Tryouts
- Day In the Life (DITL) Exercises

•Required number of Pilots and Maintainers Trained to support Instructors, OT, 33 FW Core Cadre, Service Initial OPS Squadron IOC/RFO

•Meet Annual Service/Partner Requirements for Pilots Trained

•Meet Annual Service/Partner Requirements for Maintainers Trained



F-35 Training

Pilot Simulators

Maintenance Simulators



Electronic



Software, Tech Data,
Configurations

JSF Aircraft

PTA
Pilot Training Aircraft

MRT

Mission Rehearsal

FMS

Full Mission Simulator

ASMT

Aircraft Systems
Maintenance Trainer

ESMT

Ejection System
Maintenance Trainer

WLT

Weapons Loading
Trainer





F-35 Partnership

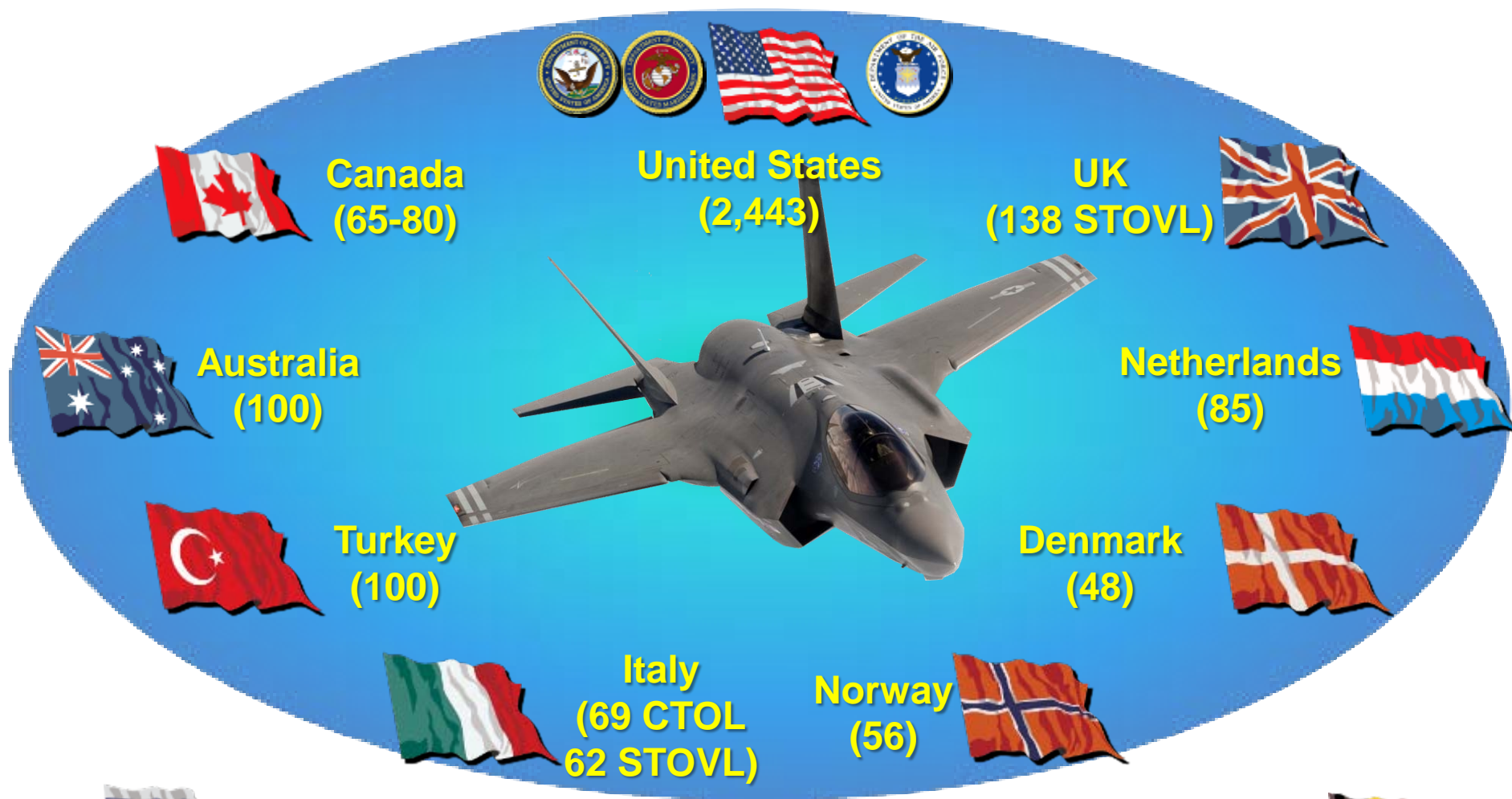

Potential FMS

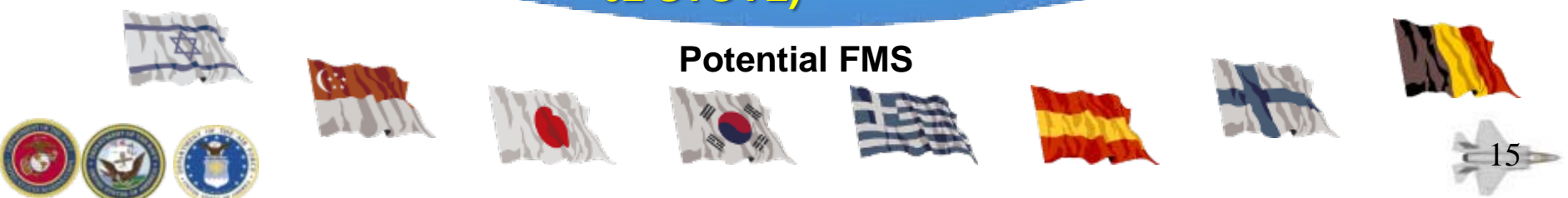



Fleets F-35 Will Replace



Domestic and UK

International

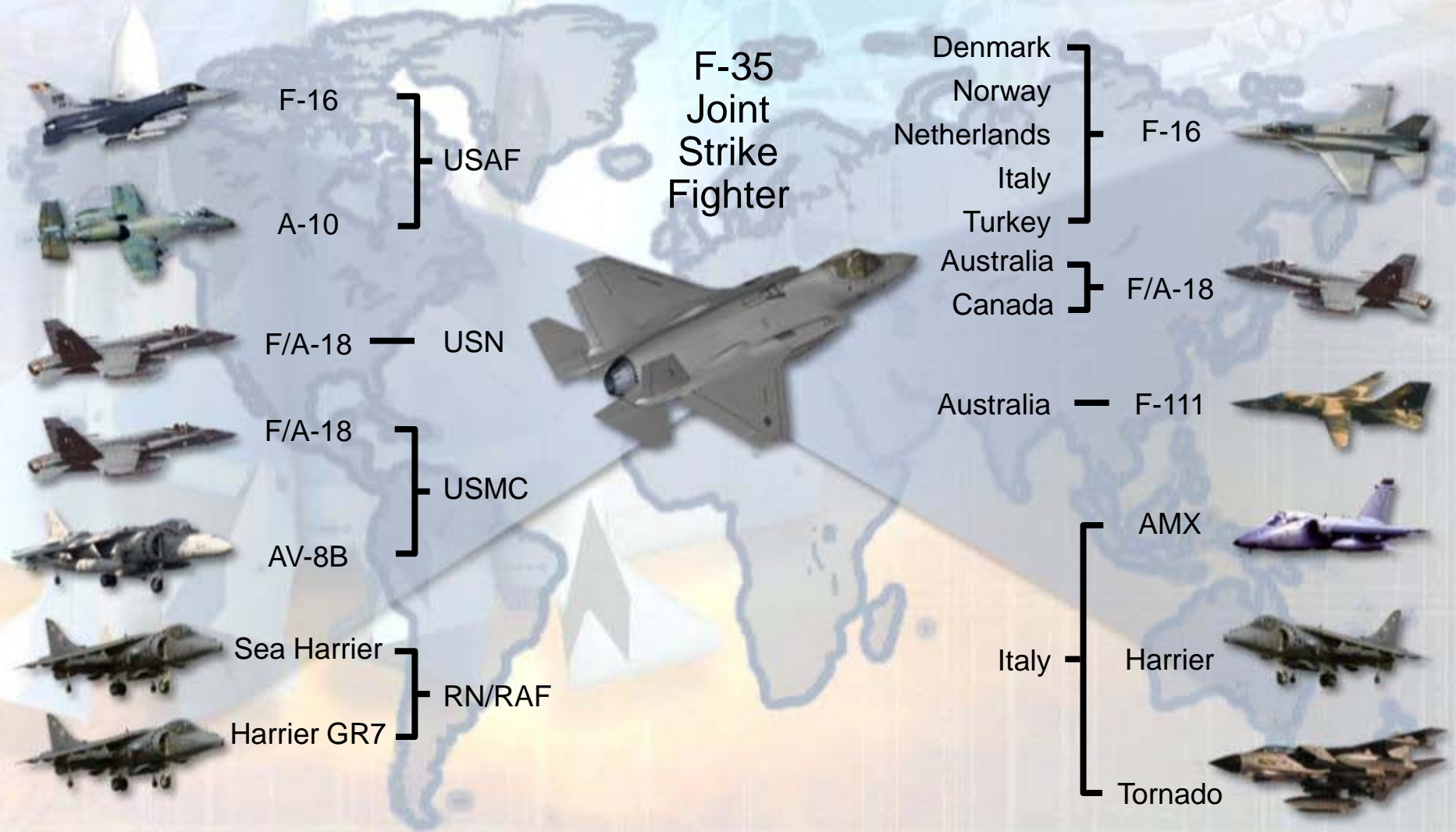



JSF Family Of Aircraft

One Program -- Three Variants
Meeting Service and International Needs

F-35A
Conventional
Take-Off and
Landing
(CTOL)



In-Flight Refueling
Door (Boom)

Internal
25mm 4-Barrel
Gatling Gun

F-35C
Carrier Variant
(CV)



Larger Wing and
Horizontal Tail Area

Probe and Drogue
Refueling (Basket)

Strengthened
Landing Gear
and Tailhook

Centerline
Gun Pod
with 25mm Gun

F-35B
Short Take-Off and
Vertical Landing
(STOVL)

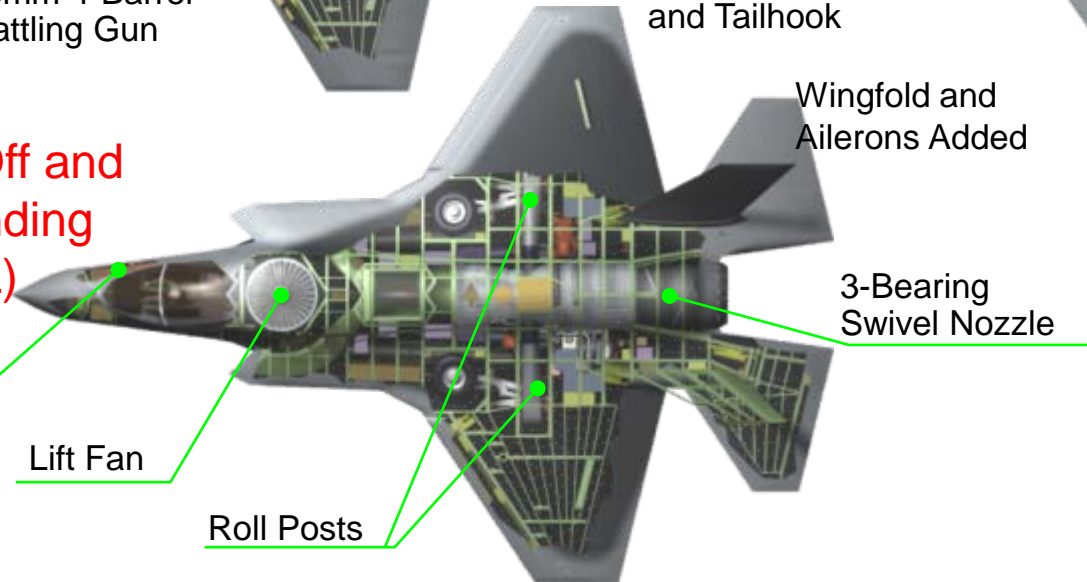

Wingfold and
Ailerons Added

3-Bearing
Swivel Nozzle

Probe and Drogue
Refueling (Basket)

Lift Fan

Roll Posts



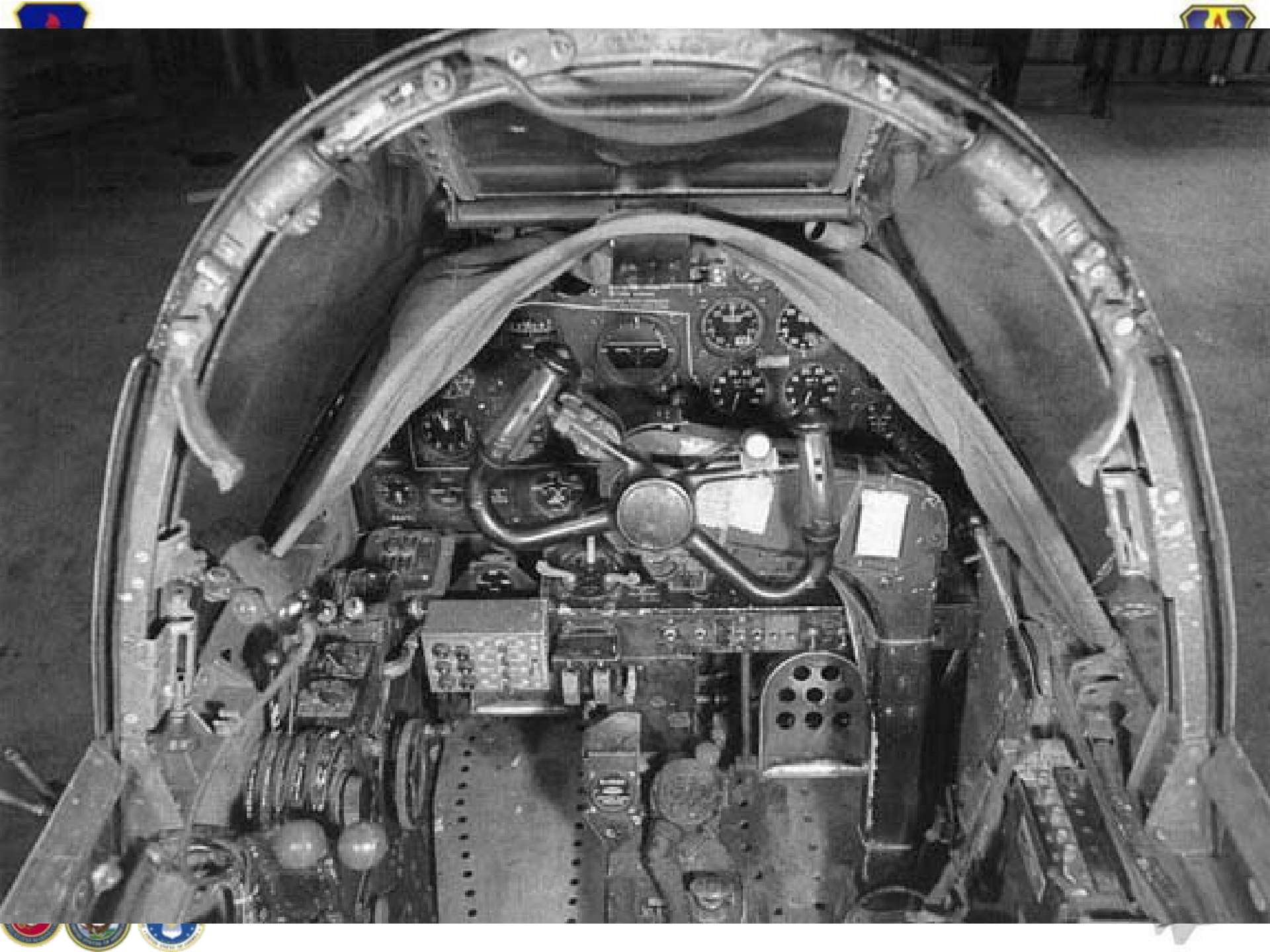







Multi-Mission Capability



- Very Low Observable Stealth
- Fighter Performance
- Integrated Sensor Fusion
- Net-Enabled Operations
- Peace Keeping Capabilities
- Advanced Sustainment

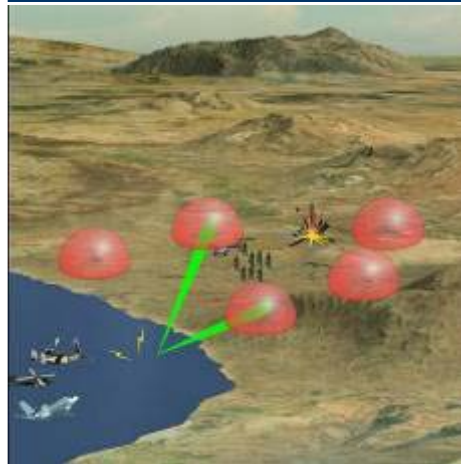
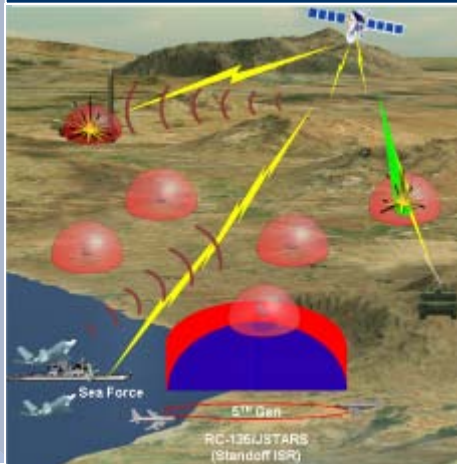
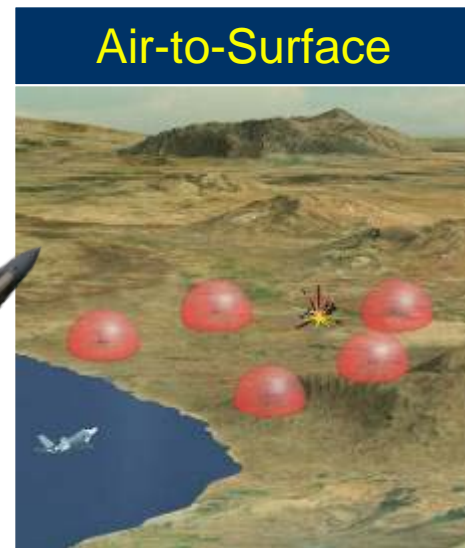



Fully Integrated Avionics & Sensors



Exceptional Situational Awareness





Weapons Carriage Requirements

Non-Technical Data



CTOL Internal Gun

Store Fully Certified During SDD

EXTERNAL WEAPONS

INTERNAL

EXTERNAL WEAPONS



426 -Gallon Wing Tank



Stormshadow

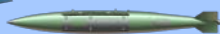

GBU-38 JDAM 500-lb (MK-82 Warhead)

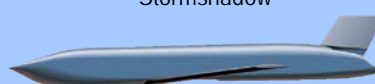

AGM-158 JASSM



MXU-648/CNU-88 Baggage Pod

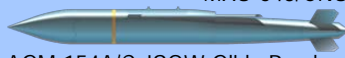

AGM-154A/C JSOW Glide Bomb



AIM-120B/C AMRAAM



GBU-31 JDAM 2,000-lb (MK-84 Warhead)



AIM-9X Sidewinder

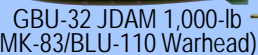

GBU-32 JDAM 1,000-lb (MK-83/BLU-110 Warhead)

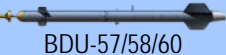

BDU-57/58/60 Laser-Guided Training Round



GBU-31 JDAM 2,000-lb (BLU-109 Warhead)

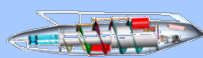

Missionized Gun



Brimstone/Joint Common Missile

MK-76/MK-58/BDU-48



GBU-32 JDAM 1,000-lb (MK-83/BLU-110 Warhead)



GBU-12 Paveway II 500-lb LGB (MK-82 Warhead)

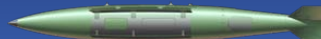

GBU-31 JDAM 2,000-lb (MK-84 Warhead)

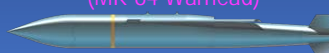

AGM-154A/C JSOW Glide Bomb



GBU-31 JDAM 2,000-lb (BLU-109 Warhead)



Brimstone/Joint Common Missile

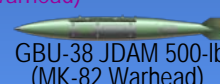

GBU-38 JDAM 500-lb (MK-82 Warhead)



AIM-120C AMRAAM



AIM-132 ASRAAM



UK 500# PGB



Phase I SDB



GBU-10 Paveway II 2,000-lb LGB (MK-84 Warhead)

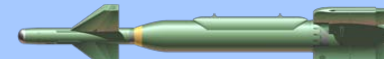

GBU-24A/B Paveway III 2,000-lb LGB (MK-84 / BLU-109 Warhead)

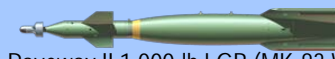

GBU-16 Paveway II 1,000-lb LGB (MK-83 Warhead)



MK-83 BLU-110 LDGP 1,000-lb LDGP



MK-83 BSU-85 HDGP

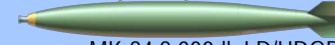

MK-84 2,000-lb LD/HDGP



MK-84 BSU-50 Ballute 2,000-lb HDGP



GBU-12 Paveway II 500-lb LGB (MK-82 Warhead)



MK-82 500-lb LD & HD

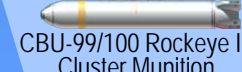

CBU-99/100 Rockeye II Cluster Munition



AIM-132 ASRAAM



Key Take Aways

- **Eglin F-35 ITC is Unique**
 - **Only joint site for pilot and maintainer training on all three variants for all US Services and Coalition Partners.**
- **ITC training success tied to:**
 - **Aircraft utilization/Availability**
 - **Effective use of shared resources**
- **F-35 will have a huge footprint across the U.S.**
 - **Ranges, Targets and EW emitters will be key to effective training**
 - **High-fidelity targets key for advanced sensors**





- Questions
- Briefer Info: Maj Michael Ebner, 58 FS, michael.ebner@us.af.mil





Backup Slides





AF Ops/AMU Hangar

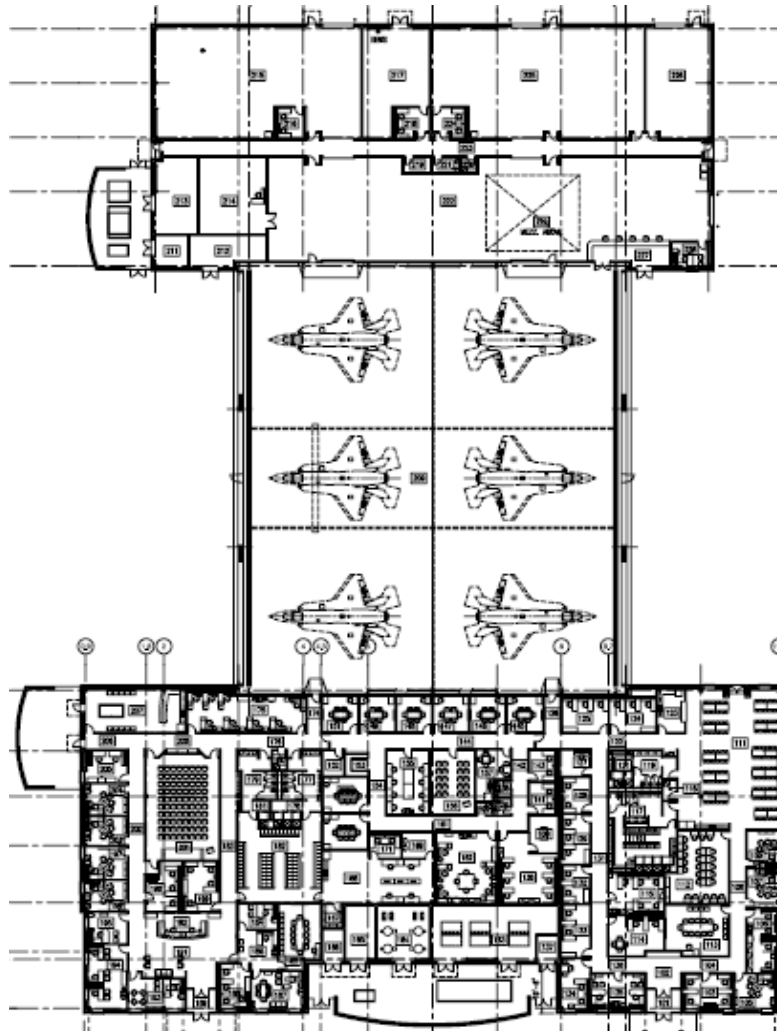

58 FS
'Gorillas'
24 x F-35A

270 ft x 400 ft
77,000 sq-ft

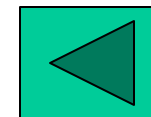



DoN Hangar

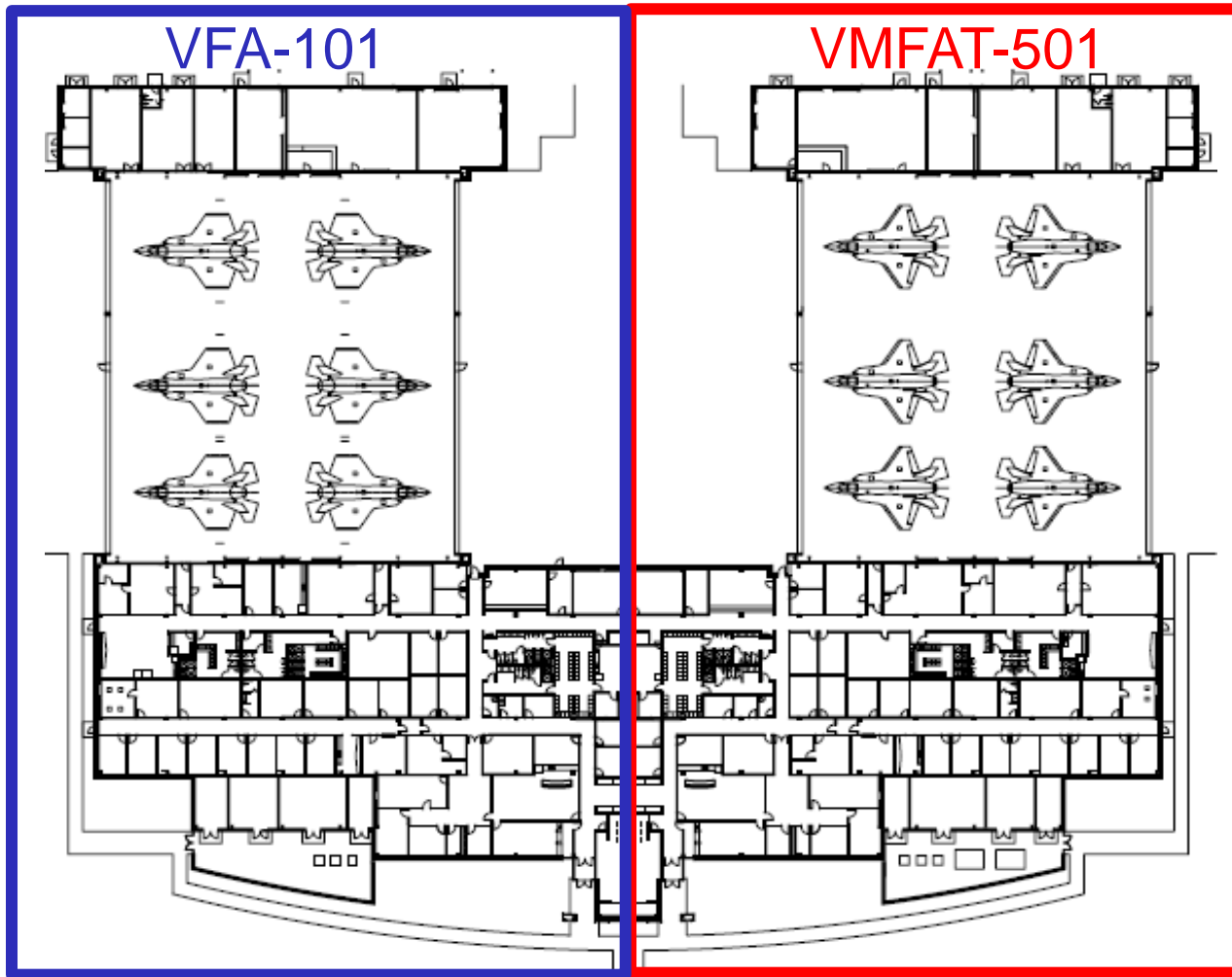

VMFAT-501

'Warlords'

- Apr 2010
- 20 x F-35B
- UK 6 jets

VFA-101

'Grim Reapers'

- Oct 2011
- 15 x F-35C

450 ft x 400 ft
110,000 sq-ft

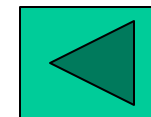



Academic Training Center

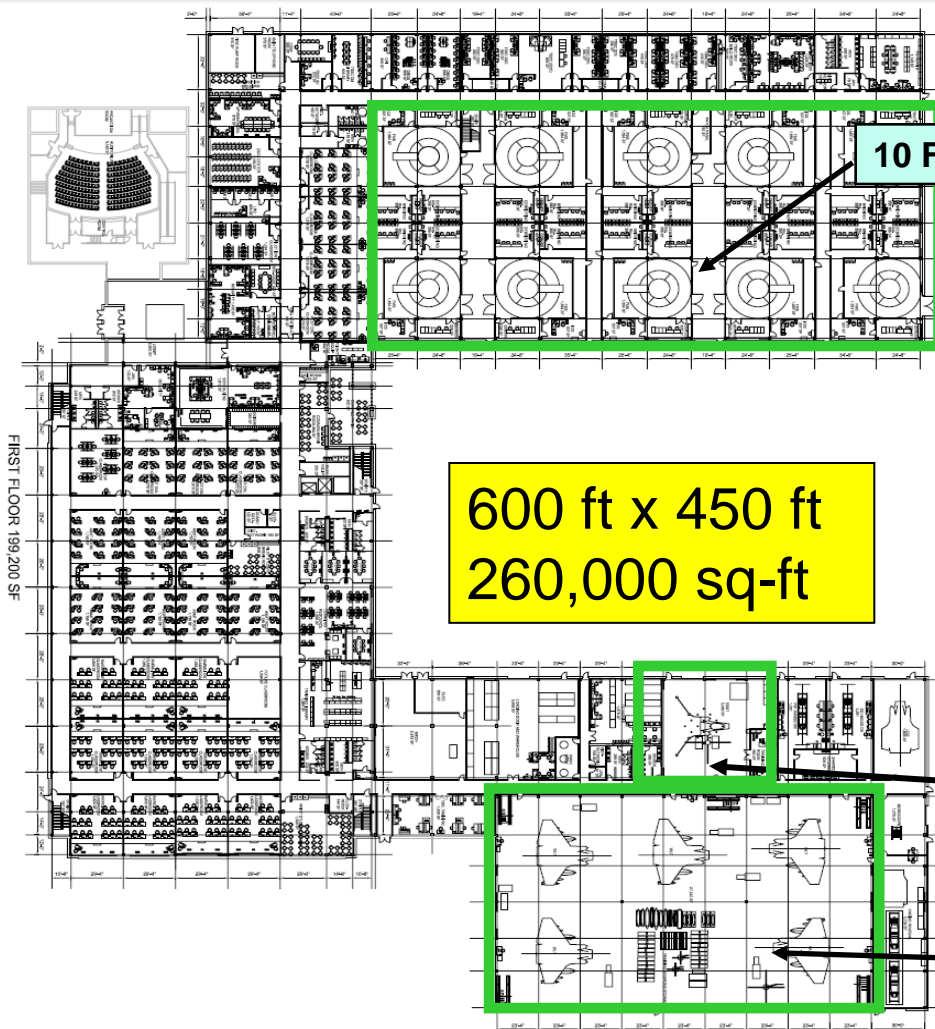

10 Full Mission Sims

600 ft x 450 ft
260,000 sq-ft

Ejection seat trainer

MX Weapons
Load Trainer Area

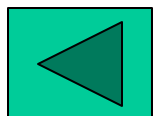
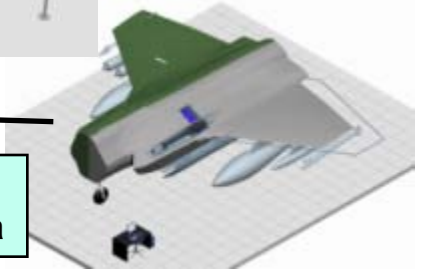
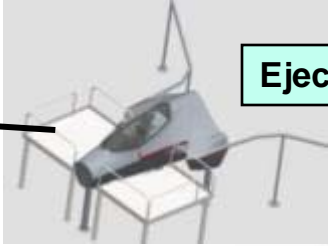
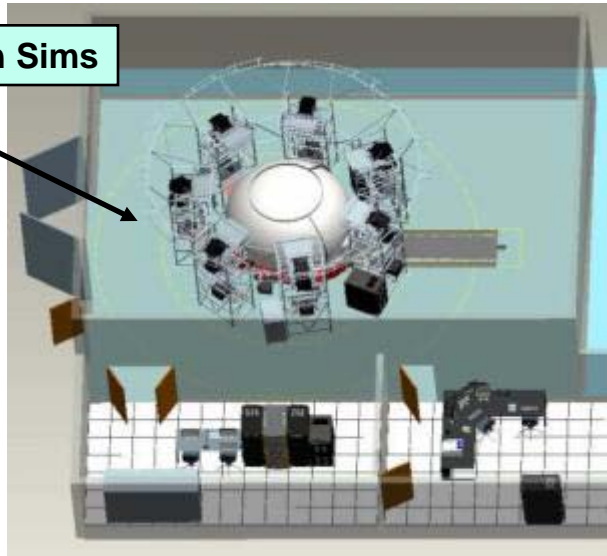

LHA DECK – STOVL Training

